

# A GUIDE TO MEETINGS, INCENTIVES, CONFERENCES & EVENTS



ATLANTIS  
THE ROYAL  
DUBAI

THE ULTIMATE DESTINATION TO MIX

# BUSINESS

WITH

# PLEASURE



# WHY DUBAI?

*It's a One-of-A-Kind Destination*

## 1 GLOBAL & EASY ACCESS

Dubai is situated in a favourable geographical position making it accessible and affordable. You can reach 80% of the world's population in less than an 8-hour flight.

## 2 WORLD'S #1 MOST COSMOPOLITAN CITY - MCKINSEY & COMPANY

Home to more than 200 nationalities living in harmony and speaking more than 140 languages.

## 3 #8 MOST DIVERSIFIED ECONOMY - DUBAI COMPETITIVENESS REPORT

Dubai has expanded rapidly over the decades and has become synonymous with global trade epicentres, leading the world in business, finance, technology innovation, manufacturing, and tourism.

## 4 21<sup>ST</sup> HAPPIEST COUNTRY - WORLD HAPPINESS REPORT

Tolerant, Hospitable & Welcoming. The inclusive nature of Dubai has evolved the city to cater to a broader range in this multicultural environment. Put on the sky - Dubai is a unique destination as both a dynamic business centre and a leisure paradise.

*"Dubai is a unique destination as both  
a dynamic business centre and a leisure paradise."*

## 5 7<sup>TH</sup> SAFEST CITY IN THE WORLD - WORLD ECONOMIC FORUM

Dubai is ranked one of the safest places on the earth in terms of digital security, health security, infrastructure and ability to recover from disasters, and personal security.



# ATLANTIS

## THE ROYAL

DUBAI

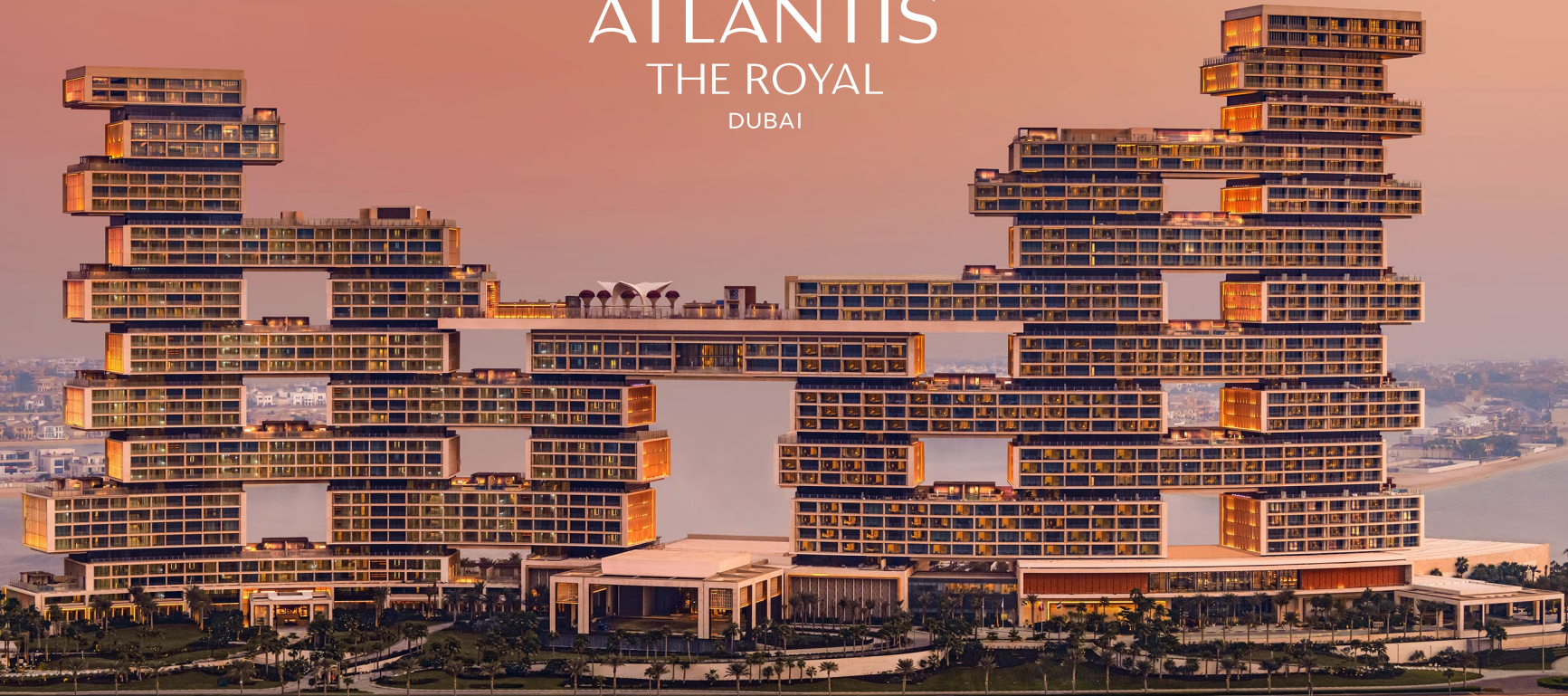

THIS IS THE MOST  
**ULTRA-LUXURY**  
EXPERIENTIAL RESORT IN THE WORLD

Crafted by the world's leading designers, architects and artists, this iconic resort is home to extraordinary stays with infinite ocean and skyline views, unparalleled dining experiences, incredible attractions, and electrifying entertainment & nightlife.

BE ONE OF THE  
**FIRST IN  
THE WORLD**

TO HOST A COVETED EVENT  
AT A PIONEERING HOTEL

---

With its striking lobby and dazzling water features dotted throughout the property, along with the city's most dramatic sky pools and some of the region's most exciting restaurants, the diverse range of entertainment and networking spaces at Atlantis The Royal provide novelty and inspiration for all attendees.



# ROOMS, SUITES & SIGNATURE PENTHOUSES

Atlantis The Royal is home to a total of 760 rooms, with 137 unique Suites, 44 with infinity pools, providing complete privacy and relaxation. Each Guest Room is thoughtfully designed to deliver unmatched comfort and refined elegance, with all rooms and suites boasting breathtaking views of the Palm Island or the Arabian Sea.

Guests can experience the world's most iconic stay in one of Atlantis The Royal's six Signature Penthouses. With hand-crafted décor, elevated service, bespoke amenities, private infinity pools, and expansive terraces, every detail is designed to inspire. The bedrooms and bathrooms exude regal sophistication, while the lounge and dining areas offer refined spaces for relaxation and entertaining. These dream-worthy Signature Penthouses are truly unlike anything else in the world.

## NO. OF ROOMS: 760

### 3 Resort Towers

- ▶ Sunset: 355 Rooms & Suites
- ▶ Sunlight: 385 Rooms & Suites
- ▶ Sunrise: 120 Rooms & Suites

6 Signature Penthouses | 131 Suites | 160 Royal Club | 463 Guest Rooms



SKY POOL VILLA - BEDROOM

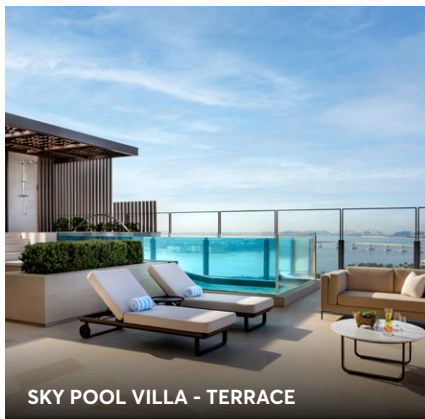

SKY POOL VILLA - TERRACE

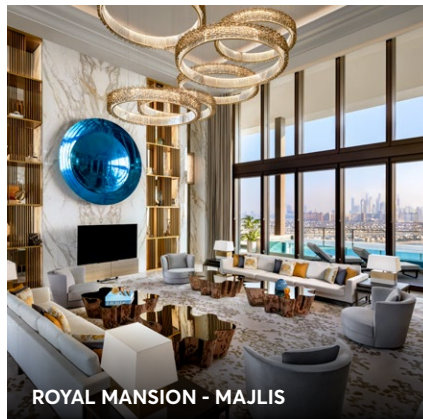

ROYAL MANSION - MAJLIS

With its iconic design and unparalleled architectural structure, Atlantis The Royal delivers the flexibility guests need when choosing their ultimate holiday destination. With a variety of connecting options available, from privatising entire floors to finding the perfect combination of Suites and Rooms for groups and larger families - Atlantis The Royal delivers the perfect stay for every occasion.

# STAYS AT ATLANTIS THE ROYAL

CATEGORY	ROOM TYPE	NO. OF ROOMS	ROOM SIZE
Standard Room	Seascape King Room	153	55m <sup>2</sup> + 9m <sup>2</sup> balcony*
	Palmscape King Room	114	
	Seascape Queen Room	109	
	Palmscape Queen Room	59	
Royal Club Rooms	Royal Club King-Sea View	50	
	Royal Club King-Palm View	45	
	Royal Club Queen-Sea View	37	
	Royal Club Queen-Sea View	28	
Family Rooms	Family Room-Sea View	22	110 sqm + Balcony
	Family Room-Palm View	6	
Suites	Sky View Suites	8	78 sqm + 18sqm Terrace
	Sky Terrace Suite	7	109 sqm + 16 sqm Terrace
	Sky Terrace Family Suite	45	
	Sky Pool Villa - Sea View	19	118 sqm + 168 sqm Terrace
	Sky Pool Villa - Palm View	19	
2/3 Bedroom Suites	Sky Terrace 2 Beds	29	164 sqm + 30 sqm Balcony
	Sky Terrace 3 Beds	4	219 sqm + 45 sqm Balcony
Signature Suites	Palmscape Penthouse	1	163 sqm + 372 sqm Terrace
	Skyscape Penthouse Sea View	1	196 sqm + 318 sqm Terrace
	Skyscape Penthouse Palm View	1	
	Horizon Penthouse	1	261 sqm + 207 sqm Terrace
	Panoramic Penthouse	1	520 sqm + 209 sqm Terrace
	Royal Mansion	1	1128 sqm + 476 sqm Terrace

\*Average size for this room category.



DIAMOND BALLROOM

# WITH ONE-OF-A-KIND SETTINGS

SUPPORTED BY STELLAR SERVICE, WE DESIGN  
EVENTS TO HELP YOU TELL YOUR UNIQUE STORY

- ▶ The multi-functional Ballroom, which can be divided into 3 completely separate spaces with individual entrances and service doors, is effortlessly elegant. At 1,000 square metres, it can comfortably sit 660 guests with a variety of seating plan options tailored to your event
- ▶ The Business District on the Galleria Level comes complete with a lounge, safety deposit box and 6 state-of-the-art meeting rooms that range from 29 square metres to 84 square metres in size, accommodating up to 12 guests per room. All can be configured in a range of different ways to suit your event. Aside from an extensive spread of culinary delights to appeal to all tastes, guests will also benefit from on-site technical expertise, state-of-the-art Audio Visual equipment and high-speed Wi-Fi making connectivity seamless
- ▶ For an extra special gathering in an intimate venue, our VIP Majlis – a traditional Arabian-styled welcome lounge – has its own private porte cochère and entrance and can accommodate up to 20 guests. The tasteful décor with its striking lighting fixtures and light-refracting mirror, complements the floor-to-ceiling windows that infuse the room with natural light

# CONFERENCE CENTRE

Conference Centre Lobby	Galleria Level	<ul style="list-style-type: none"><li>• Conference Centre Port Cochère</li><li>• 3 vehicle lanes</li><li>• 2 Reception counters</li></ul>	
Ballrooms	Galleria Level	<ul style="list-style-type: none"><li>• Main Ballroom, which can be split into 3 sections with individual entrances and service doors</li></ul>	<ul style="list-style-type: none"><li>• Seating capacity approx. 660</li><li>• Size approx. 1,000 m<sup>2</sup></li></ul>
Meeting Rooms	Galleria Level	<ul style="list-style-type: none"><li>• 6 Meeting Rooms with reception</li><li>• Business District Lounge</li></ul>	<ul style="list-style-type: none"><li>• Ave. seating 12 guests per room</li><li>• Coffee/tea + snack station</li></ul>
Business District	Galleria Level	<ul style="list-style-type: none"><li>• Same entry to Meeting Rooms</li><li>• 3 workstations (PC + printer)</li><li>• Safety Deposit Box</li></ul>	<ul style="list-style-type: none"><li>• Size approx. 40 m<sup>2</sup></li></ul>
VIP Majlis	Galleria Level	<ul style="list-style-type: none"><li>• Private VIP Porte Cochère</li><li>• Private Reception and Majlis</li></ul>	<ul style="list-style-type: none"><li>• Size approx. 150 m<sup>2</sup></li><li>• Seating capacity approx. 20</li></ul>
Bridal Suite	Galleria Level	<ul style="list-style-type: none"><li>• Dressing room with walk-in wardrobe and vanity</li><li>• Hair salon and shower</li><li>• Majlis seating area convertible to dining area</li></ul>	<ul style="list-style-type: none"><li>• Size approx. 80 m<sup>2</sup></li><li>• Seating capacity approx. 10</li></ul>

# FLOOR PLAN

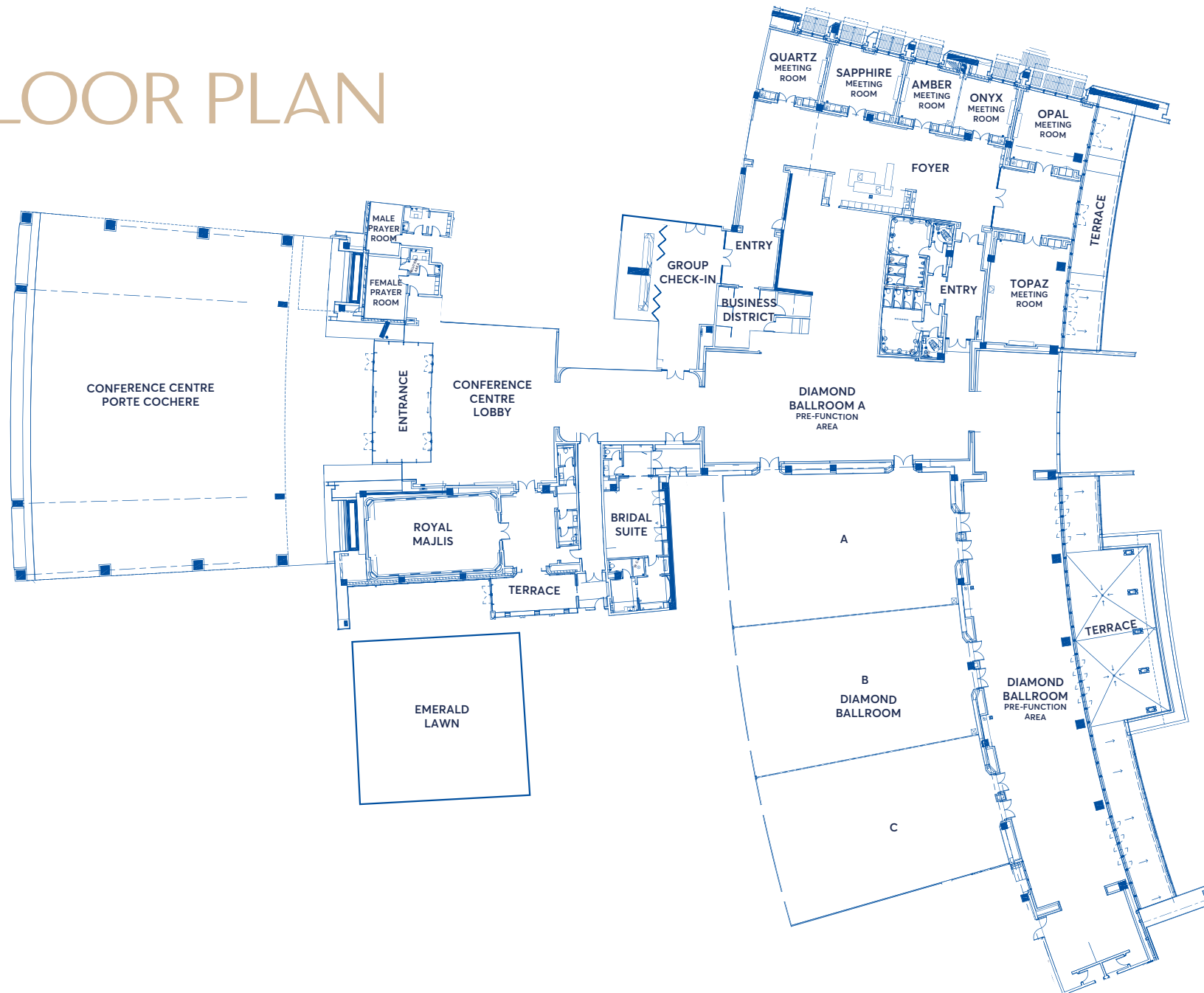

# CONFERENCE CENTRE

Room Name	Dimensions	Ceiling	Area	Reception	Banquet	Theater	Classroom	Boardroom	U Shape
<b>Amber</b>	6.6m x 5.9m	3.0m	35.40 m <sup>2</sup>	0	0	0	0	12	0
<b>Amber + Onyx</b>	6.6m x 11.6m	3.0m	69.53 m <sup>2</sup>	0	0	0	0	24	0
<b>Business District Terrace</b>	4.2m x 24.9m	0.0m	90.20 m <sup>2</sup>	100	0	0	0	0	0
<b>Diamond Ballroom</b>	24.9m x 46.5m	8.5m	1,018.80 m <sup>2</sup>	1,200	660	1173	648	0	102
<b>Diamond Ballroom A</b>	24.1m x 16.0m	8.5m	341.70 m <sup>2</sup>	400	216	414	234	0	78
<b>Diamond Ballroom AB</b>	24.4m x 31.3m	8.5m	680.10 m <sup>2</sup>	800	378	748	396	0	96
<b>Diamond Ballroom B</b>	24.1m x 15.5m	8.5m	338.40 m <sup>2</sup>	400	180	414	234	0	78
<b>Diamond Ballroom BC</b>	24.4m x 30.9m	8.5m	677.10 m <sup>2</sup>	800	378	748	396	0	0
<b>Diamond Ballroom C</b>	24.1m x 15.5m	8.5m	338.70 m <sup>2</sup>	400	162	412	231	0	0
<b>Diamond Ballroom Main Foyer</b>	27.6m x 13.3m	8.5m	301.10 m <sup>2</sup>	300	0	0	0	0	0
<b>Diamond Ballroom Terrace</b>	8.6m x 44.7m	8.5m	239.40 m <sup>2</sup>	250	0	0	0	0	0
<b>Diamond Ballroom Pre-Function</b>	61.0m x 121.9m	8.5m	601.20 m <sup>2</sup>	500	0	0	0	0	0
<b>Emerald Lawn</b>	16.7m x 28.9m	0.0m	483.20 m <sup>2</sup>	500	280	552	288	0	0
<b>Onyx</b>	6.3m x 5.8m	3.0m	34.10 m <sup>2</sup>	10	0	0	0	10	0
<b>Opal</b>	8.0m x 7.8m	3.0m	56.50 m <sup>2</sup>	0	0	0	0	18	0
<b>Quartz</b>	7.2m x 6.3m	3.0m	42.54 m <sup>2</sup>	0	0	0	0	10	0
<b>Sapphire</b>	7.0m x 7.5m	3.0m	47.87 m <sup>2</sup>	0	0	0	0	10	0
<b>Topaz</b>	11.4m x 8.2m	3.0m	83.58 m <sup>2</sup>	0	60	56	36	18	24

\* Due to layout and shape of Diamond ballroom dimensions shown are approximate indication and not to scale.

# DINING EXPERIENCE

## AT ATLANTIS THE ROYAL

A culinary destination, Atlantis The Royal is home to 16 restaurants and bars with 7 celebrity chef restaurants.



### CARBONE

DUBAI

CARBONE Dubai brings back the golden age of dining with New York charm, bold Italian-American classics, and theatrical flair, set against mid-century glamour and a bar that glows late into the night.

Operating Hours: Dinner, daily  
(Days & hours of operation are subject to change)  
Seating Capacity: 240 guests  
Indoor: 140 guests | Outdoor: 100 guests



### D I N N E R

by heston blumenthal



Dinner by Heston Blumenthal restaurant offers diners a cutting-edge take on historic British cuisine dating back to the 1300s.

Operating Hours: Daily, 6pm - 11pm  
Seating Capacity: 178 guests  
Indoor: 146 guests | Outdoor: 32 guests



### la mar

gastón acurío

2025 | MICHELIN Selected Restaurant

The first traditional cebicheria in Dubai, La Mar is a celebration of the sea, Peruvian cuisine and life, showcasing the diverse flavours and cultural richness of Peru.

Operating Hours: Daily, 6pm - 11pm  
Seating Capacity: 197 guests  
Indoor: 142 guests | Outdoor: 55 guests

# DINING EXPERIENCE

## AT ATLANTIS THE ROYAL

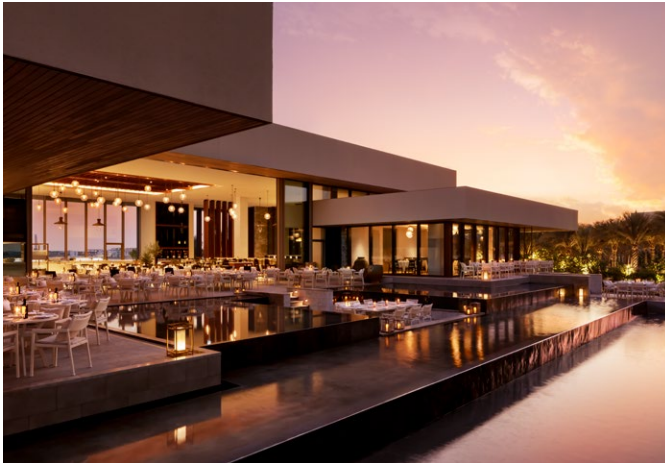

2025 | MICHELIN Selected Restaurant

One of the finest Mediterranean seafood restaurants with uninterrupted views of Skyblaze Fountain.

Opening Hours: Monday - Thursday, 12pm - 4pm | 6pm - 1am  
Friday - Sunday, 12pm - 1am  
Seating Capacity: 345 guests  
Indoor: 169 guests | Outdoor: 176 guests



2025 | MICHELIN Selected Restaurant

Modern and refined take on the ancient and authentic Persian cuisine served family-style.

Operating Hours: Daily, 12pm - 3pm | 6pm - 11pm  
Seating Capacity: 182 guests  
Indoor: 110 guests | Outdoor: 72 guests

# DINING EXPERIENCE

## AT ATLANTIS THE ROYAL



LingLing

Destination lounge and restaurant with a bar and rooftop terrace serving contemporary Asian cuisine with stunning views.

Restaurant & Bar: Daily, 6pm - 1am  
Ultra Lounge: Friday - Saturday, 11pm - 3am  
Seating Capacity: 380  
Indoors 294 - Outdoor 86

GASTRONOMY

The ultimate destination for a flavorful feast, featuring 18 live cooking stations and countless buffet stations, this is all-day dining like it's never been seen before.

Operating Hours: Daily, 7am - 12pm | 6pm - 11pm  
Seating Capacity: 960 guests  
Indoor: 650 guests | Outdoor: 310 guests

# DINING EXPERIENCE

## AT ATLANTIS THE ROYAL

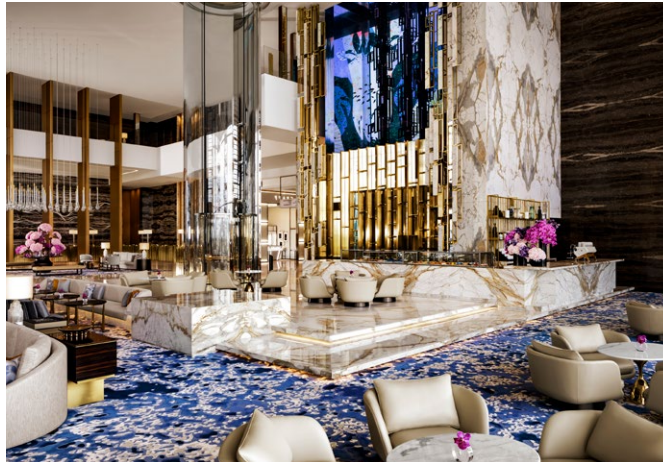

A sophisticated tearoom in collaboration with Pastry Chef Christophe Devoille serving all-day light snacks, refreshments & afternoon tea.

Operating Hours: Daily, 8am - 12am  
Seating Capacity: 136 guests  
Indoor: 136 guests

## SEASCAPES

An idyllic beach bar serving a colourful selection of international dishes, and premium E-shisha.

Operating Hours: Daily, 2pm to 9pm,  
(closed in the summer)  
Seating Capacity: 70 guests  
Outdoor: 70 guests

# DINING EXPERIENCE

## AT ATLANTIS THE ROYAL



## MALIBU

90265

A West Coast inspired American Diner serving traditional Californian cuisine.

Operating Hours: Lunch & Dinner, daily  
Seating Capacity: 169 guests  
Indoor: 93 guests | Outdoor: 76 guests

## HOUSE OF DESSERTS

Home to Dubai's finest artisan gelato, a result of carefully chosen ingredients, genuine craftsmanship, and the science and creativity of our chefs

Operating Hours: Daily, 12pm - 10pm  
Seating Capacity: 30 guests  
Indoor: 30 guests

# ATLANTIS THE ROYAL DUBAI

RESORT

RESIDENCES

SUNSET TOWER

SUNLIGHT TOWER

SUNRISE TOWER



## DINING, BARS & LOUNGES

- 1 Milos
- 2 La Mar
- 3 Dinner by Heston Blumenthal
- 4 Ling Ling
- 5 Ariana's Persian Kitchen
- 6 Gastronomy
- 7 Malibu 90265
- 8 Cloud 22
- 9 Nobu by the Beach
- 10 Elements Terrace
- 11 The Royal Tearoom
- 12 Seascapes
- 13 House of Desserts
- 14 Royal Club Sea Lounge
- 15 Carbone Dubai

## LEISURE & ENTERTAINMENT

- 1 Skyblaze Fountain
- 2 Aquaventure Waterpark
- 3 Royal Pool
- 4 AWAKEN Wellness
- 5 Royal Beach
- 6 Tennis Courts
- 7 Atlantis Explorers Club
- 8 Alkemy Salons
- 9 Watersports Beach Hut
- 10 Nobu by the Beach Pool
- 11 Private Residences Pool
- 12 AEON

## RETAIL

- 1 Tanagra
- 2 Valentino
- 3 Damas
- 4 Brunello Cucinelli
- 5 Level Shoes
- 6 Dolce & Gabbana x Ounass
- 7 100% Capri
- 8 Avanti by Rivoli Vision
- 9 Orlebar Brown
- 10 Graff
- 11 Louis Vuitton
- 12 Royal Boutique

## GUEST SERVICES

- 1 Hotel Lobby
- 2 Concierge & Guest Services
- 3 Medical Clinic

## POINTS OF INTEREST

- Washrooms
- ATM
- Prayer Rooms
- Aquaventure Buggy Stop
- Shuttle Pick-up Point



ATLANTIS  
THE ROYAL  
DUBAI

For more information, please email [groups@atlantisdubai.com](mailto:groups@atlantisdubai.com)