

# BALLROOMS AND CONFERENCE ROOMS

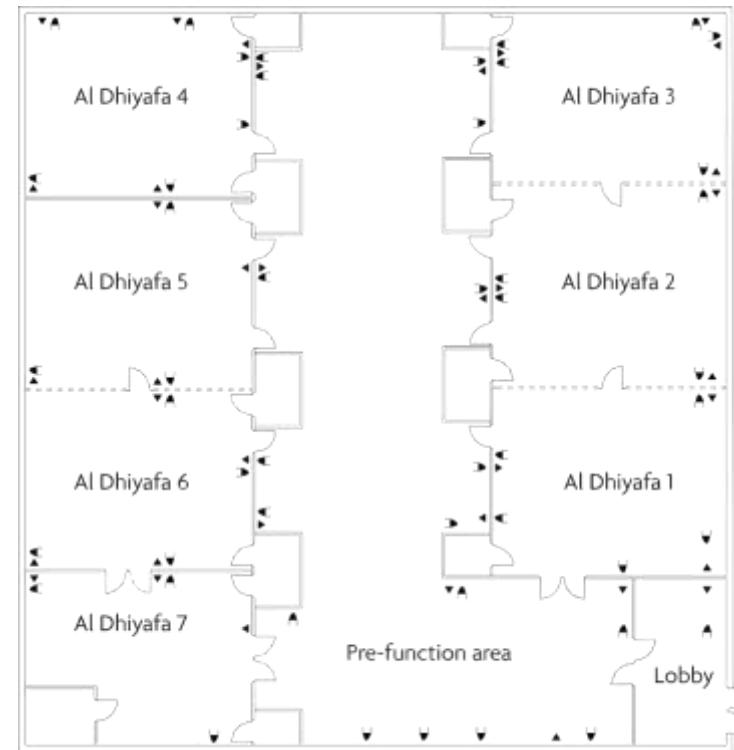
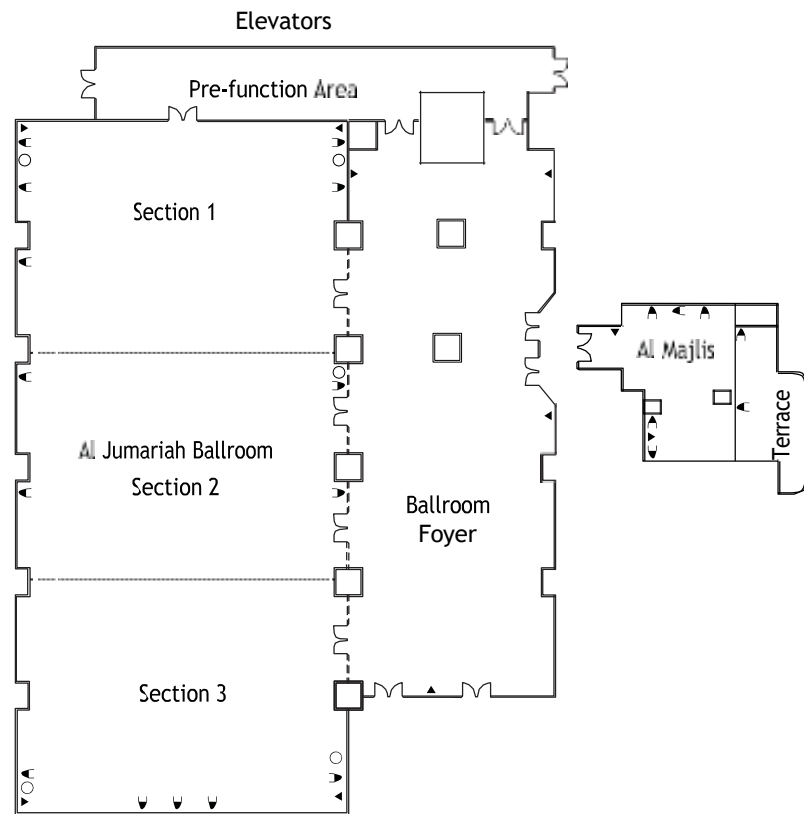

## KEY

- ⏏ Power point
- ▲ Telephone or ISDN point
- Television socket

Note: Room diagrams are not to scale











MILLENNIUM PLAZA  
DOWNTOWN HOTEL

T. +971 4 331 1111 F. +971 4 331 5555

E. h1031.fo11@millenniumhotels.com

W. [www.millenniumhotels.com](http://www.millenniumhotels.com)

P.O. Box 23215 Sheikh Zayed Road,  
Dubai

Conference Rooms	 Reception	 Theatre	 Classroom	 Boardroom	 Banquet	 Dimensions (m)	 Height (m)	 Door H/W (m)	 Location (floor)
Al Jumairah Ballroom	1800	1400	800	180	1000	49 x 23	4.48	2.03 x 0.94	2
Ballroom Section 1	400	350	160	60	250	16 x 23.3	4.48	2.03 x 0.94	2
Ballroom Section 2	400	350	160	60	250	16 x 23	4.48	2.03 x 0.94	2
Ballroom Section 3	400	350	160	60	250	16 x 23	4.48	2.24 x 1.07	2
Ballroom Foyer	600	-	-	-	-	40 x 14.3	4.48	2.93 x 3.34	2
Al Majlis	60	60	50	30	60	8.2 x 15.9	2.25	2.2 x 1.70	2
Al Safa 1 + 2	60	80	30	30	40	16.2 x 7.8	3.15	2.1 x 1.65	3
Al Safa Room 1	20	30	15	10	20	7.5 x 7.8	3.15	2.1 x 1.65	3
Al Safa Room 2	25	35	15	16	20	8.6 x 7.8	3.15	2.1 x 1.65	3
Royal Majlis	-	-	-	14	-	7.2 x 6.4	2.8	2.05 x 1.46	17
Al Dhiyafah Pre-function Area	300	-	-	-	-	32 x 14	2.7	1.6 x 2.7	3
Al Dhiyafah 1+2+3	300	200	120	70	200	24.4 x 10.2	3.16	2.05 x 1.7	3
Al Dhiyafah 1	50	60	27	30	40	8.3 x 10.2	3.16	2.05 x 1.7	3
Al Dhiyafah 2	50	60	27	30	40	8.2 x 10.2	3.16	2.05 x 0.9	3
Al Dhiyafah 3	50	60	27	30	40	7.9 x 10.2	3.16	2.05 x 0.9	3
Al Dhiyafah 4	35	40	27	30	40	8 x 9.9	3.16	2.05 x 0.9	3
Al Dhiyafah 5+6	70	100	60	40	100	16.2 x 9.9	3.16	2.05 x 0.9	3
Al Dhiyafah 5	35	40	30	22	40	8.3 x 9.9	3.16	2.05 x 0.9	3
Al Dhiyafah 6	35	40	30	22	40	7.8 x 9.9	3.16	2.05 x 0.9	3
Al Dhiyafah 7	-	-	-	14	-	7.6 x 9.9	3.16	2.05 x 1.7	3

All measurements are approximate and in meters