

MEET & MINGLE



ALOFT CITY CENTRE DEIRA, DUBAI

Located within the cultural heart of Dubai, Aloft City Centre Deira offers urban cool on the creek. Situated close to the business hubs of the city and a short walk to Dubai Metro, the hotel offers a convenient location for savvy meetings and events.

Stylish and flexible, our meeting space offers cutting-edge A/V, fast & free WiFi. Pop over to W XYZ® bar for a break, stay fit 24/7 at Re:charge gym, relax by Splash with outstanding city views and so much more.

Aloft City Centre Deira, Dubai

Baniyas Road, Deira
P.O. Box 22533, Dubai, United Arab Emirates

+971 4 210 3333 | aloftcitycentredeira.com | @AloftDubai

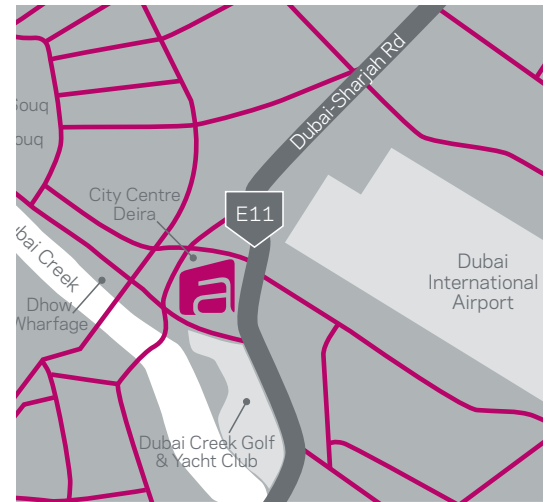

ASLEEP

Total guestrooms and suites

304

King guestrooms

151

Twin guestrooms

128

Savvy Suites

21

Cinema Suites

4

AWAKE

HAN SHI FU

Signature modern Chinese dining.

VOX Cinemas OUTDOOR

Licensed cinema.

W XYZ bar

Sip specialty cocktails, enjoy tasty bites and more.

Re:fuel by AloftSM

Grab & go gourmet available 24/7.

Leisure

Stay fit at Re:charge gym or take a dip at Splash pool.

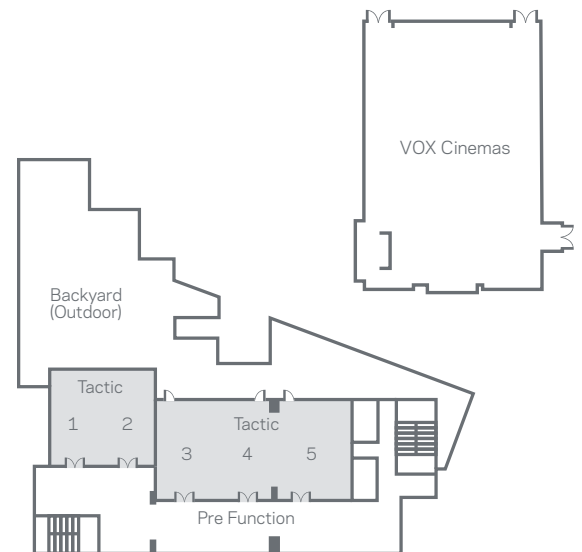

Aloft City Centre Deira

Room Size (Feet)	Room Size (Meters)	Ceiling Height	Room Area (FT ²)	Room Area (M ²)	Banquet	Theater	Conference	Reception	Classroom	U-Shape	Hollow Square	Dinner Dance
------------------	--------------------	----------------	------------------------------	-----------------------------	---------	---------	------------	-----------	-----------	---------	---------------	--------------

Room Size (Feet)	Room Size (Meters)	Ceiling Height	Room Area (FT ²)	Room Area (M ²)	Banquet	Theater	Conference	Reception	Classroom	U-Shape	Hollow Square	Dinner Dance	
First Floor													
tactic 1	28'7" x 15'5"	8.7 x 4.7	-	431	40	28	46	12	40	30	12	14	26
tactic 2	28'7" x 14'9"	8.7 x 4.5	-	420	39	28	46	12	40	30	12	14	26
tactic 3	30'2" x 18'8"	9.2 x 5.7	-	560	52	36	50	16	48	33	16	18	34
tactic 4	30'2" x 15'9"	9.2 x 4.8	-	474	44	28	46	12	44	30	12	14	26
tactic 5	30'2" x 23'1"	9.2 x 7.03	-	689	64	46	56	22	54	40	20	22	42
tactic 1 & 2	28'7" x 30'2"	8.7 x 9.2	-	850	79	56	94	24	80	60	24	28	52
tactic 3 & 4	30'2" x 34'5"	9.2 x 10.5	-	1033	96	66	96	28	92	70	28	32	62
tactic 3, 4 & 5	30'2" x 58'5"	9.2 x 17.8	-	1755	163	112	134	50	146	110	48	54	96
Pre-Function 3, 4 & 5	15'9" x 68'11"	4.8 x 21.0	-	1076	100	-	-	-	100	-	-	-	-
Backyard (Outdoor)	32'10" x 45'11"	10.0 x 14.0	-	1507	140	112	152	50	146	110	48	54	104